



BEAVER ELECTRICAL MACHINERY
 7440 LOWLAND DRIVE, BURNABY, BC, CANADA
 TEL: (604) 431-5000 FAX: (604) 431-5066
 www.beaverelectrical.com

TVR SERIES SPECIFICATION SHEET

3 PHASE TRANSFORMER TYPE: DRY TYPE FLOOR OR WALL MOUNT

CAT. NO.: TVR75H-S34A3
 KVA: 75
 PRIMARY VOLT: 208 ▲
 SECONDARY VOLT: 480Y/277
 PHASE: 3
 FREQ: 60 HZ
 WINDING MATL: Aluminum
 WEIGHT: 550 LBS
 INSUL. CLASS: 220°C
 TEMP. RISE: 150°C
 IMPEDANCE: 4.0 - 5.0%
 TAPS: SEE BELOW
 BIL: 10 kV
 ENCLOSURE: NEMA 1
 NEMA 3R with optional kit
 EFF. STANDARDS: NRCAN 2019, DOE 2016
 APPROVALS: UL, CSA

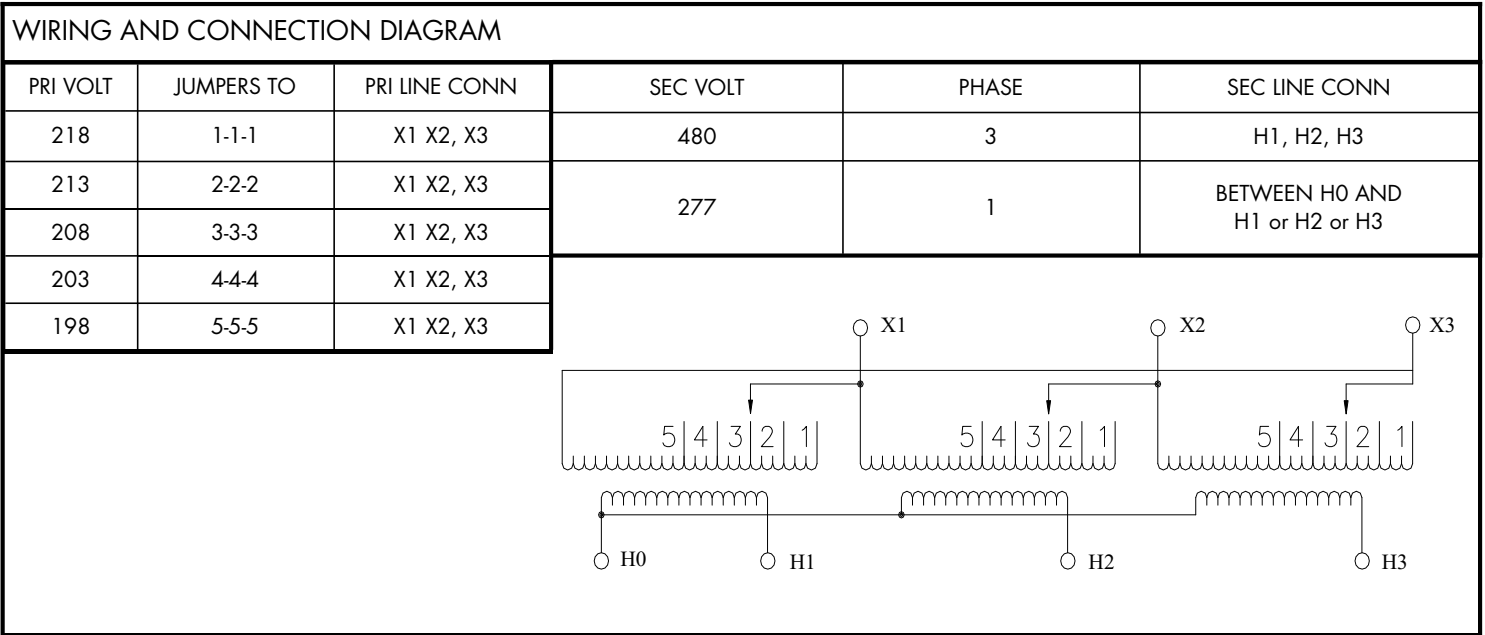
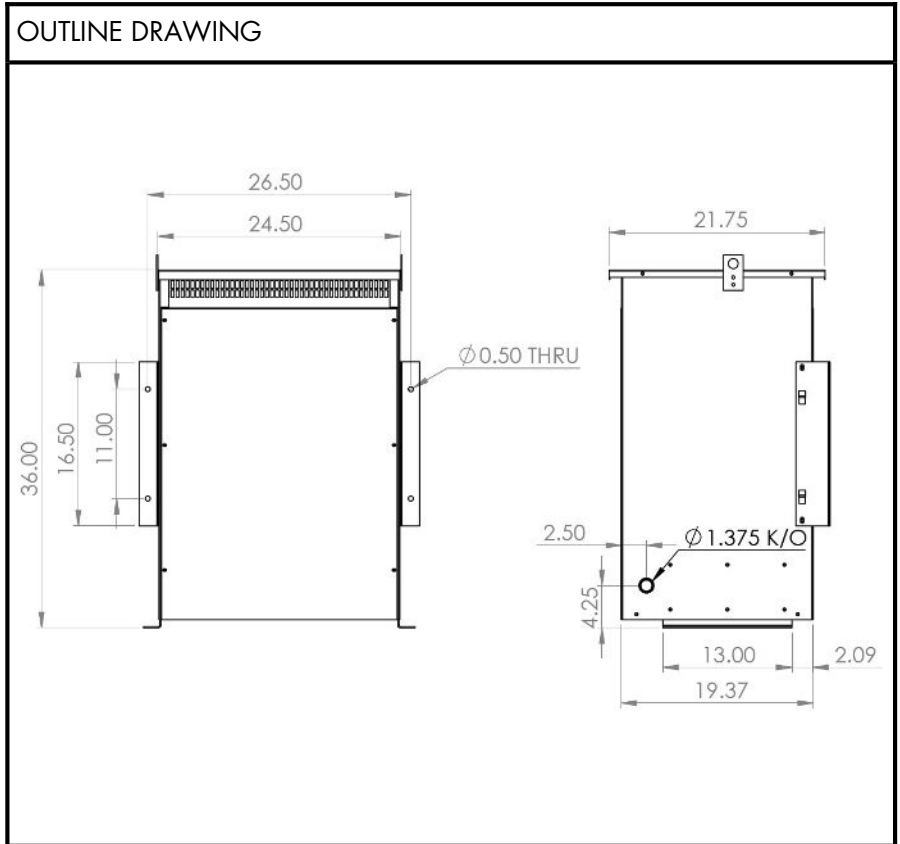

NOTE: Specifications and dimensions subject to change without notice